

GM0600 QD-槍膛安裝教程

GM0600 QD-CHAMBER SET INSTALLATION GUIDE

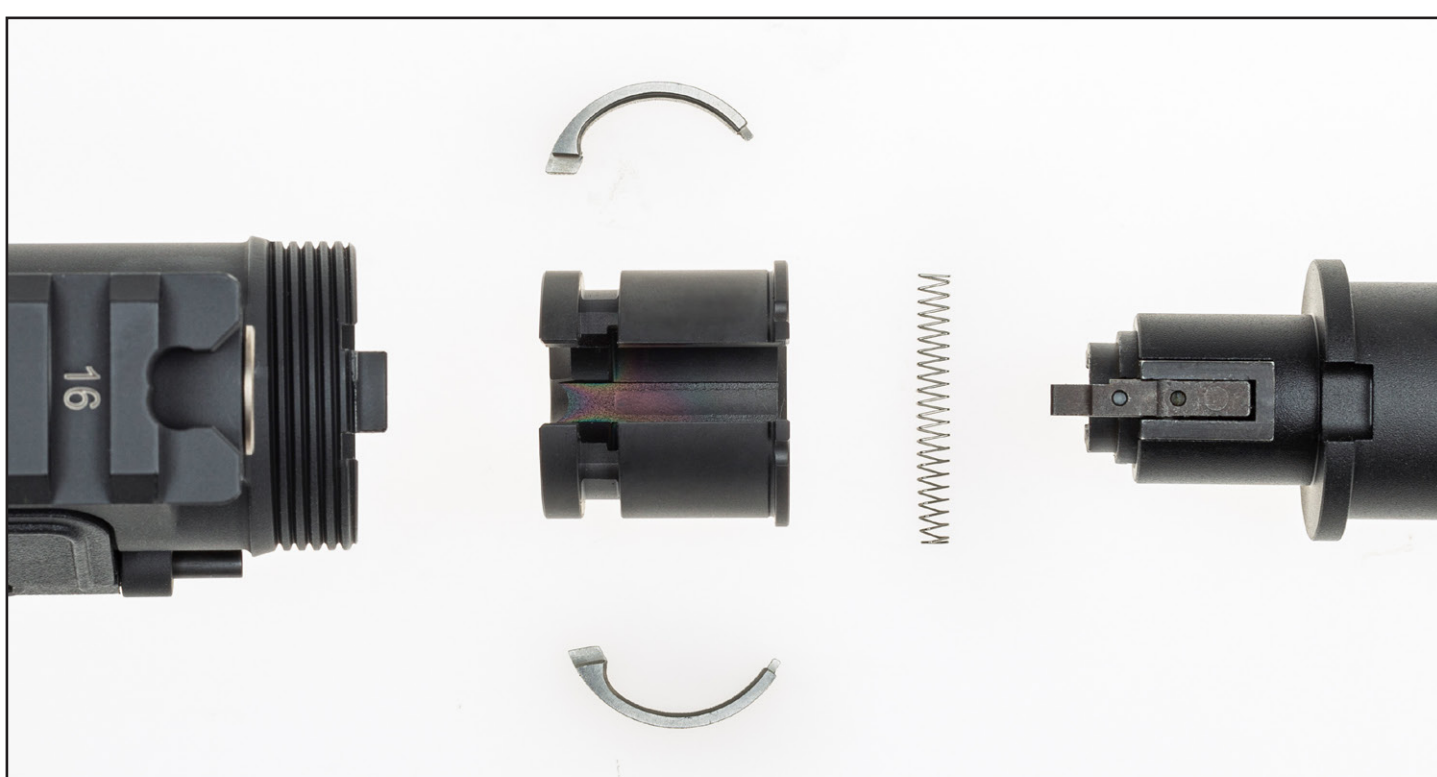

·GM0600 适用于 GM MWS AR / A5 上機匣的 QD-槍膛套件
 ·GM0600 QD-Chamber Set For GM MWS AR / A5 Receiver

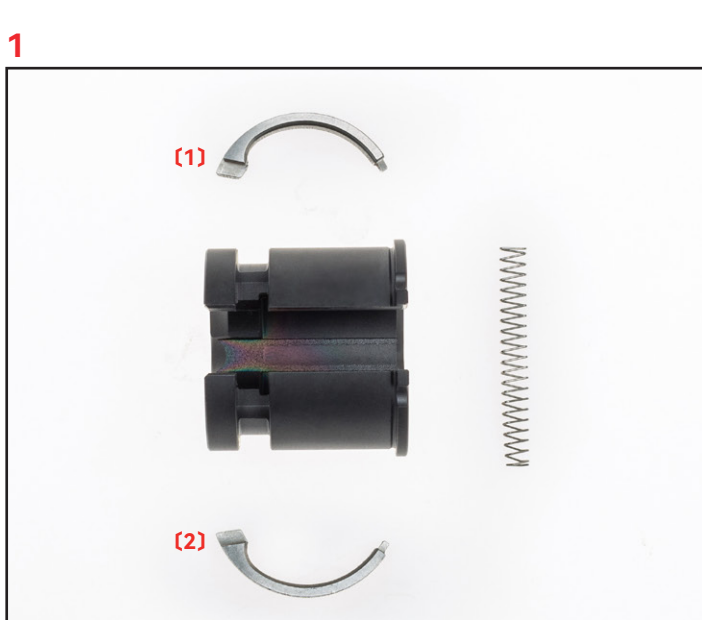

·先將鎖定零件 (1) 和 (2) 安裝到槍膛上，務必注意缺口方向，確保安裝正確。
 ·First, install locking parts (1) and (2) onto the chamber. Be sure to align the notch orientation correctly to ensure proper installation.

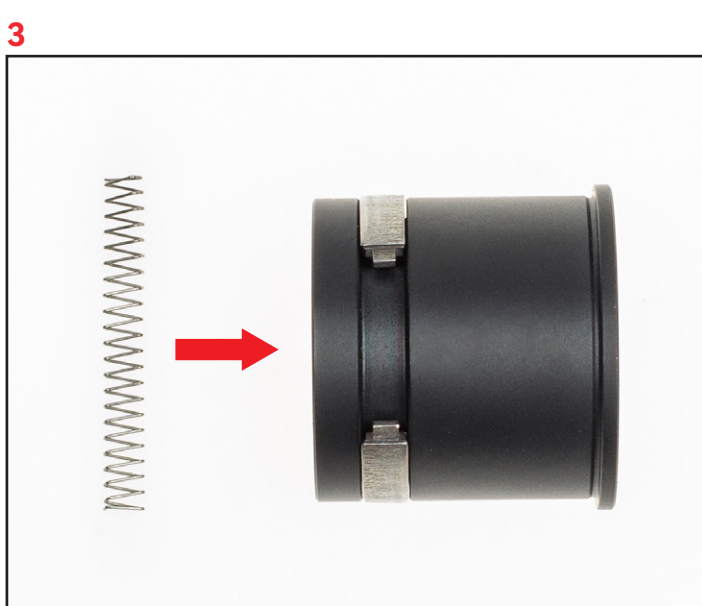
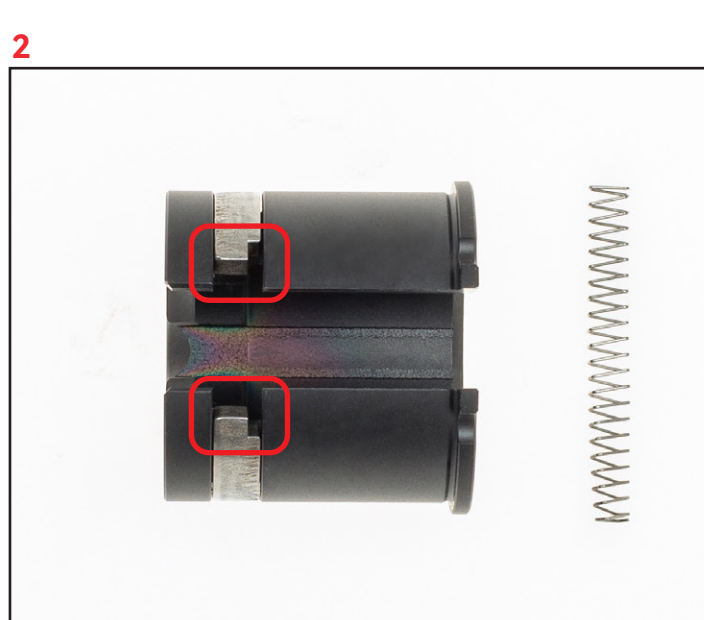

·將槍膛翻轉，於鎖定零件尾部裝入彈簧。操作時請用手指按住鎖定零件，以防彈簧彈力導致零件鬆脫或彈飛。
 ·Flip the chamber over, and insert the spring into the tail end of the locking part. During the operation, please use your finger to hold down the locking part, to prevent the part from loosening or being ejected due to the spring's tension.

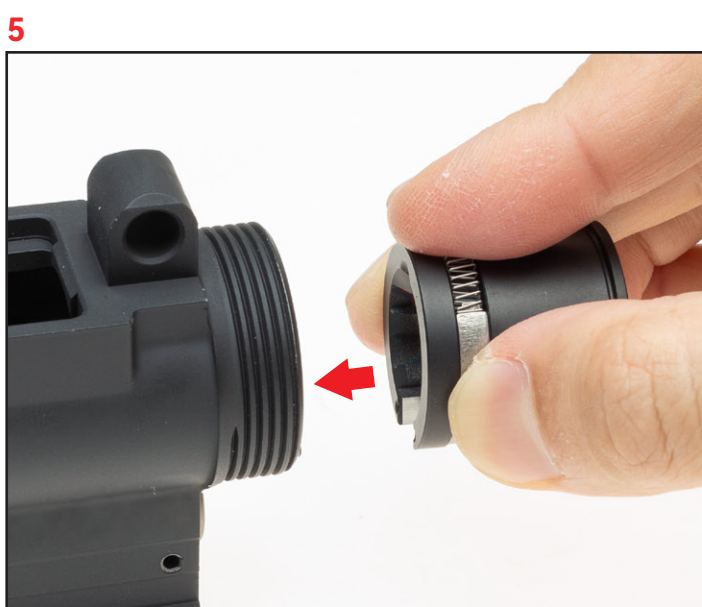

·操作時請用手指持續按壓鎖定零件與彈簧，使其完全貼合凹槽，同時將槍膛平穩推入上機匣。並務必確認鎖定零件與彈簧已進入超過一半深度，被上機匣穩固卡住且無彈出風險後，方可鬆手。
 ·During the operation, please use your finger to keep pressing the locking part and spring, ensuring they are fully seated in the groove. Meanwhile, gently push the chamber into the upper receiver. Do not release your hold until you have confirmed that the locking part and spring are inserted more than halfway, are securely retained by the upper receiver, and there is no risk of them springing out.



·推入槍膛時，注意鎖定零件與彈簧貼合凹槽的狀態，若未完全貼合則會導致卡住而無法順利推進。完全裝入時要對準上機匣的卡槽位 (3)。
 ·When pushing the chamber in, pay attention to the seating condition of the locking part and spring in the groove. If they are not fully seated, it will cause a jam and prevent smooth insertion. During final assembly, align it with the locking groove (3) on the upper receiver.

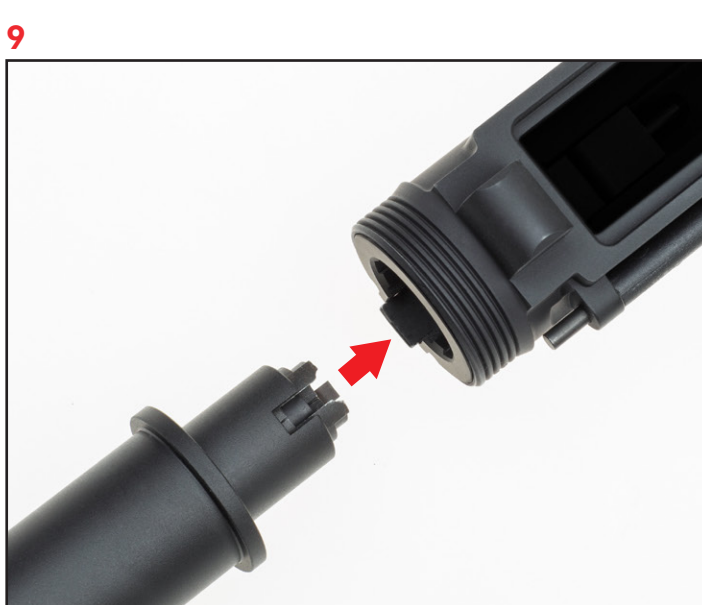
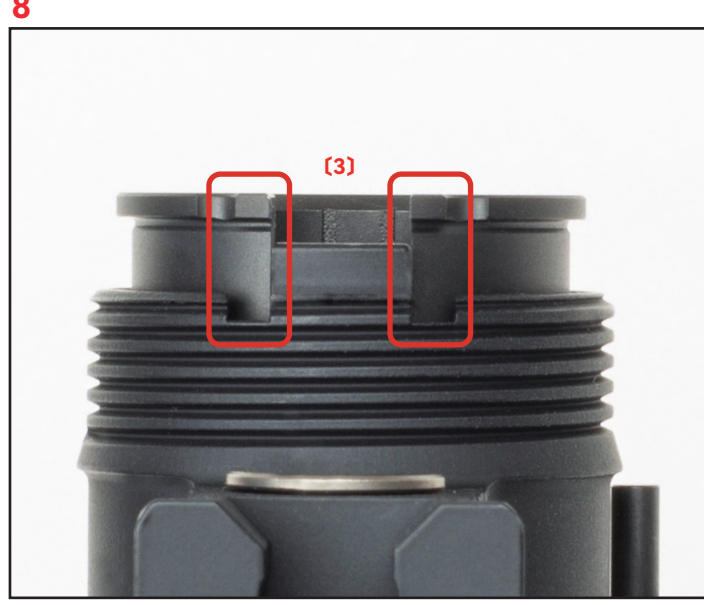

·安裝槍管時，需先以一字螺絲刀推開鎖定零件，隨後將槍管推入定位。為確保安裝到位，可使用購買氣槍時附帶的小工具輔助卡住鎖定零件。
 ·When installing the barrel, first use a flathead screwdriver to release the locking part, then slide the barrel into position. To ensure it is fully seated, you may use the small tool included with the airsoft gun to help secure the locking part in place.

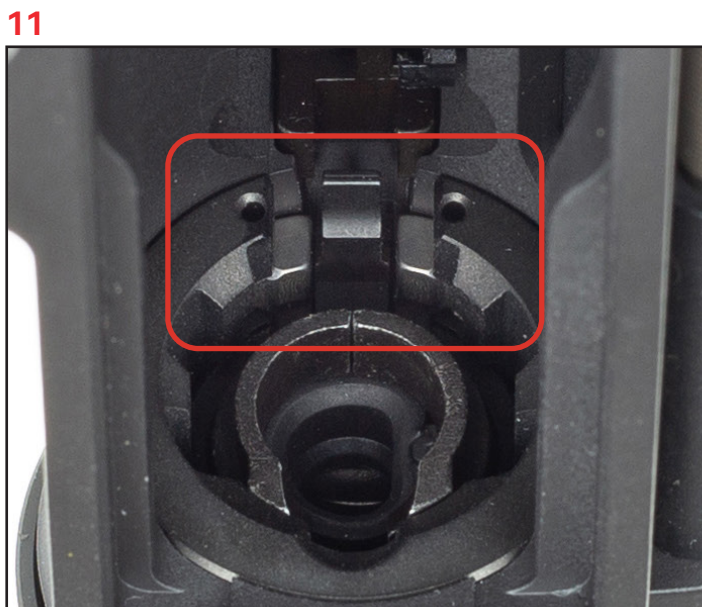

·如圖所示，槍管內管座鎖定到位後，安裝完成。
 ·As shown in the figure, once the inner barrel seat is locked into position, the installation is complete.



小貼士

PRO TIP

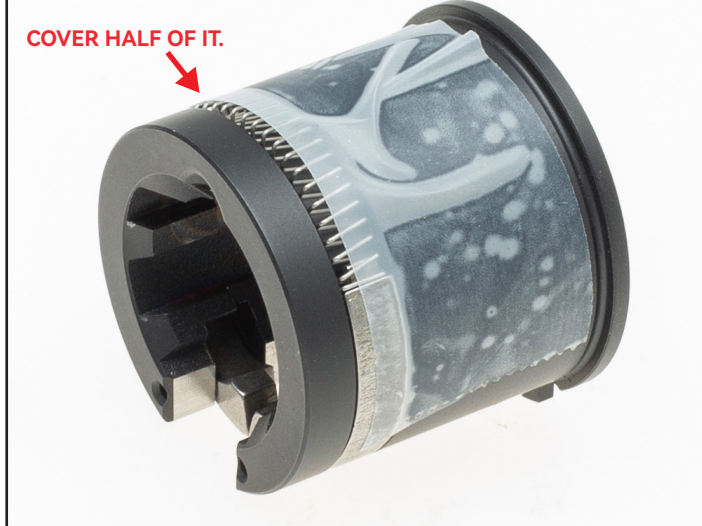

·為方便安裝，可使用不留膠痕的貼紙暫時固定。如圖所示，將貼紙覆蓋鎖定零件和彈簧的一半，防止組裝時偏移。
 ·To facilitate installation, a piece of non-residue adhesive tape can be used for temporary fixation. As shown in the figure, apply the tape over half of the locking part and spring to prevent misalignment during assembly.



·確認鎖定零件與彈簧已進入超過一半深度，被上機匣穩固卡住且無彈出風險後，即可撕下貼紙。
 ·Once you have confirmed that the locking part and spring are inserted more than halfway, are securely retained by the upper receiver, and there is no risk of them springing out, you may remove the tape.

